



Valet Central Vacuum Systems

INSTALLATION & OPERATION MANUAL



Enjoy the peace of mind that comes with the generous Valet Five Year Warranty



Return the warranty card or register your warranty online to get an extra year warranty for free

VALET WARRANTY PERIODS

CENTRAL VACUUM POWER UNITS

5 Years Warranty + 1 Year Bonus Warranty
(V-TEN Power Unit has 10 years warranty for domestic use)

INTERCOM SYSTEMS & SECURITY SYSTEMS

3 Years Warranty + 1 Year Bonus Warranty

VACUUM TOOLS, BRUSHES, ACCESSORIES

1 Year Warranty + 1 Year Bonus Warranty

REPLACEMENT VACUUM MOTORS

1 Year Warranty applies to either owner-installed or dealer-installed replacement motors

iCentralTM

Intelligent Central Systems

A DIVISION OF **NESS** CORPORATION

THE HOME OF

VALET

www.valet.com.au

SALES - SERVICE - SPARES

☎ 1800 050 333

NESS HEAD OFFICE

☎ 02 8825 9222



Valet Central Vacuum Installation & Operation manual.
Rev 4, February 2017

COPYRIGHT NOTICE

All rights reserved. No part of this publication may be reproduced, transmitted or stored in a retrieval system in any form or by any means, electronic, mechanical, photocopying, recording, or otherwise, without the prior written permission of Ness. Ness reserves the right to make changes to features and specifications at any time without prior notification in the interest of ongoing product development and improvement.

© Ness Corporation Pty Ltd ABN 28 069 984 372

CONTENTS

INSTALLATION

Safety Instructions	4
Your Valet Power Unit / Contents	5
Easy Steps to Installation	6
Low Voltage Wiring	7
Connecting The Switch Input	8
Fitting The Filter Bag (Bagged models)	8
Good Installation Standards, Diagrams	9
PVC Fittings & Duct	10
Inlet Valves	11
Installation in Existing Homes & New Constructions	12
Vacuum Hoses & Cleaning Tools	13

OPERATION

Operating Your Central Vacuum System, Overview	16
How To Change The Bag (Bagged units)	17
How to Empty The Dirt Canister (Cyclonic & Inverted bag units)	18
Troubleshooting Guide	19
Troubleshooting Guide, Remedies	20-22
Warranty Card	23-24

Valet Central Vacuum Installer's Manual

This product is intended only for Household and Light Commercial Use

IMPORTANT SAFETY INSTRUCTIONS

PLEASE READ THIS PAGE BEFORE INSTALLATION OR USE

- Read the Installation Manual and ensure correct Installation
- Read the User Manual and ensure correct use of the product/s at all times
- Check and empty the dust bag or bin regularly
- Do not install outside unless proper weather protection is in place
- Do not connect to a non grounded supply or a non approved supply
- Do not service the Motor Unit unless it has been disconnected from the supply
- Do not use with a damaged electrical lead or plug
- Keep the electrical lead away from heated or sharp objects
- Keep inflammable objects or liquids away from the Motor Unit
- Do not place or store anything on top of the Motor Unit
- Do not place or store anything that may restrict the air flow of the Motor Unit
- Do not vent the Motor Unit into a wall, a ceiling, or any enclosed space
- Do not vacuum any wet surfaces
- Do not vacuum any liquids, including any fuels
- Do not vacuum anything that is hot, burning or smoking
- Do not vacuum any ash, even if it appears dormant
- Avoid vacuuming plaster dust or talcum powder, which can cause clogging and bursting of vacuum bags
- Do not obstruct, block or impede the hose or wall valve inlets
- Keep hair, all parts of the body and loose clothing away from the hose or wall inlets
- Do not use non recommended attachments or accessories
- Pay close attention to children while the system is being used
- Do not allow children to use the system as a toy

WARNING
**IMPROPER USE MAY CAUSE FIRE,
ELECTRIC SHOCK OR INJURY**

YOUR VALET POWER UNIT



CARTON CONTENTS



BAG ADAPTOR fits into the vacuum inlet on the canister. The bag adaptor mouth is aligned at 90° inside the bag.



INLET PLUG used to block the unused vacuum inlet on the canister.



CLAMP COUPLING used to connect the muffler to the Exhaust Outlet.



90° ELBOW for fitting the muffler. (Supplied with some models)



12" MUFFLER connects to the Exhaust Outlet. (Supplied with some models)

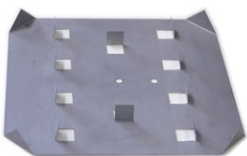

BOTTOM BAFFLE sits on the bottom of the canister. NOTE the correct way up (shown upside down in this photo)



A **VACUUM BAG** is supplied with each power unit. 1 x Max-Flo HEPA bag or 1 x Valet Universal blue bag depending on the model

ORDER SPARE VACUUM BAGS ONLINE
www.valet.com.au

Part No. VAC-122
Genuine Valet Blue Vacuum Bags 3 Pack

Part No. VAC-123
Genuine Valet White Max-Flo™ HEPA Vacuum Bags 2 Pack

CENTRAL VACUUM INSTALLATION GUIDE

PLAN AHEAD

Planning is the key to a successful Central Vacuum installation. Essentially, the plan will come down to determining the best location for the wall inlet valves and the power unit.

From there, the pathway for the PVC ducting should, wherever possible follow the most direct and shortest run.

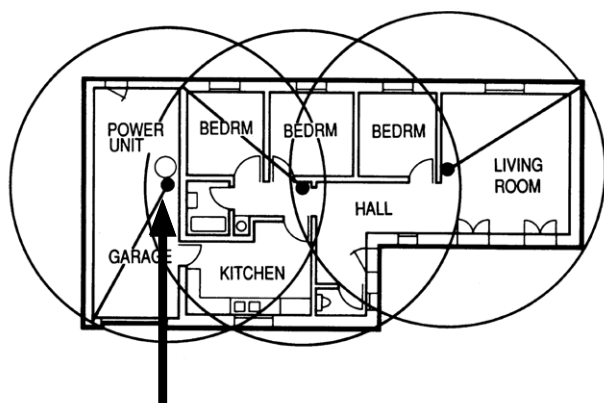

Power unit in the garage

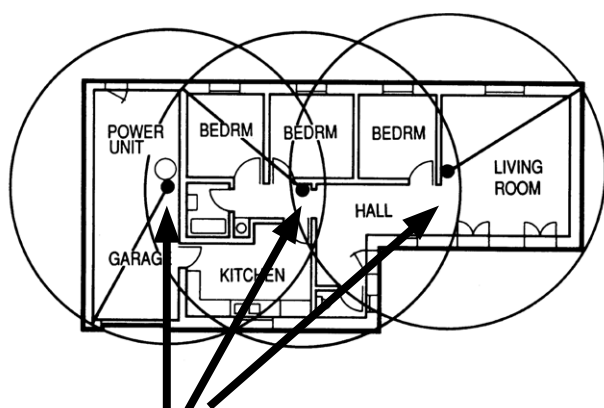

Three inlet example

i Lay out your inlet locations on a plan of the premises.

POWER UNIT CHOICE

To select the correct the correct power unit for the premises, calculate the distance of PVC pipe required from the power unit to the last inlet valve and add 1m for each PVC fitting in that line.

EASY STEPS TO INSTALLATION

STEP 1

POWER UNIT LOCATION

The power unit can usually be installed in a garage, basement or utility room. If it needs to be located externally, proper weatherproofing is essential and the correct model must be used.

It is generally best to choose a location near an exterior wall to minimize the length of the exhaust run.

The power unit should not be boxed in or enclosed to allow the motor to freely draw fresh air and blow exhaust air.

Remember that the unit should be accessible for easy replacement of the bag or emptying the dust bin.

A 230 Volt mains electrical outlet is required within a metre of the power unit.

STEP 2

INLET VALVE LOCATIONS

Inlet valves are usually placed on interior walls, in hallways, near doorways or close to the bottom of stairways. Potential furniture placement should be considered when determining valve locations.

The objective is to use as few inlet valves as possible to achieve maximum use of the 9 metre hose, while providing whole house coverage.

Inlet valves can be situated between studs, clear of obstructions like plumbing, wiring, heating ducts, etc. They are typically positioned level with the height of electrical outlets.

In new home installations, the system should be installed at "frame" stage.

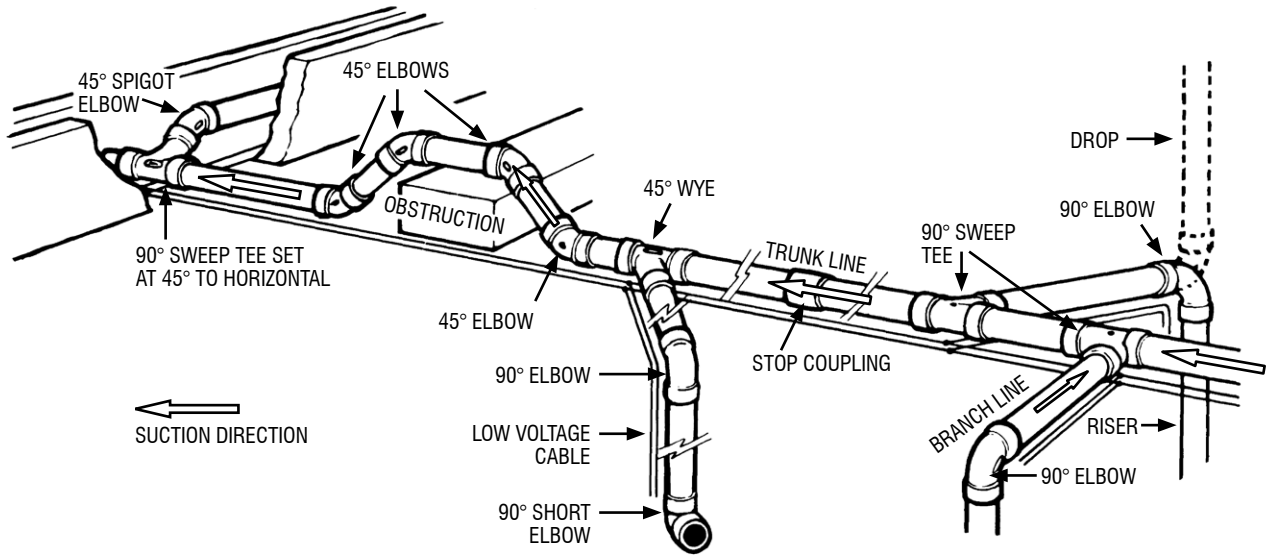

STEP 3

PVC DUCTING

Ducting and low voltage wiring are run together from the Power Unit to each valve location, in the most direct line possible. The wiring can be looped or terminated at each inlet valve

The amount of airflow that is achieved at the hose is dependent on the efficiency of the layout of the PVC ducting.

Keep the line as straight as possible and avoid using tight 90° fittings (except at each inlet) and try to use 90° sweeps wherever possible.

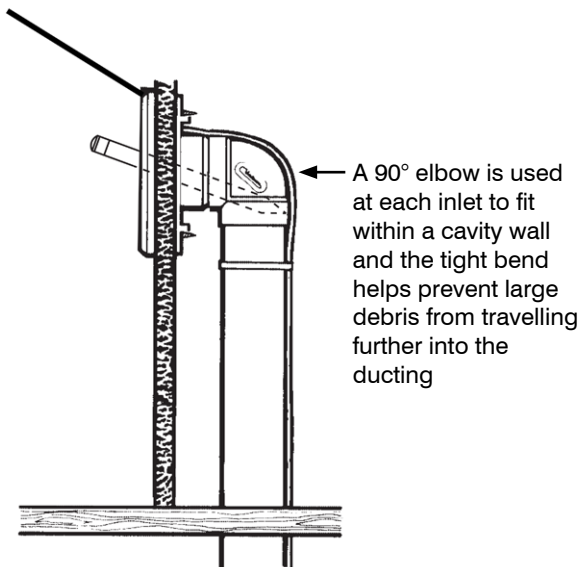

LOW VOLTAGE WIRING

Figure 8 low voltage wiring/cable is readily available throughout Australia, generally in 14/0.20 or 24/0.20 gauges.

It is recommended that you always use good quality cable, and be careful to run and secure the cable in a manner that will provide the best protection from future damage. The cable is usually best run together with the PVC ducting, and can usually be strapped to the ducting.

The cable will run from the motor to the first inlet valve and then loops to the next inlet valve and so on. It is recommended that the connections are made at the inlet valves so they are accessible in the future, rather than join the cable at PVC junctions that may be difficult to access and to service in the future.

Leave a certain amount of cable slack - Too little can be a problem with not enough cable to work with or not enough for future rework of the connection but also too much can be difficult to push back into the wall.

Damaged or faulty cable, which is rare, can be substituted by wireless switching devices if absolutely necessary. Ask your Valet dealer about the VAC-292 Wireless Hose Kit.

LOW VOLTAGE WIRING TO INLET VALVES

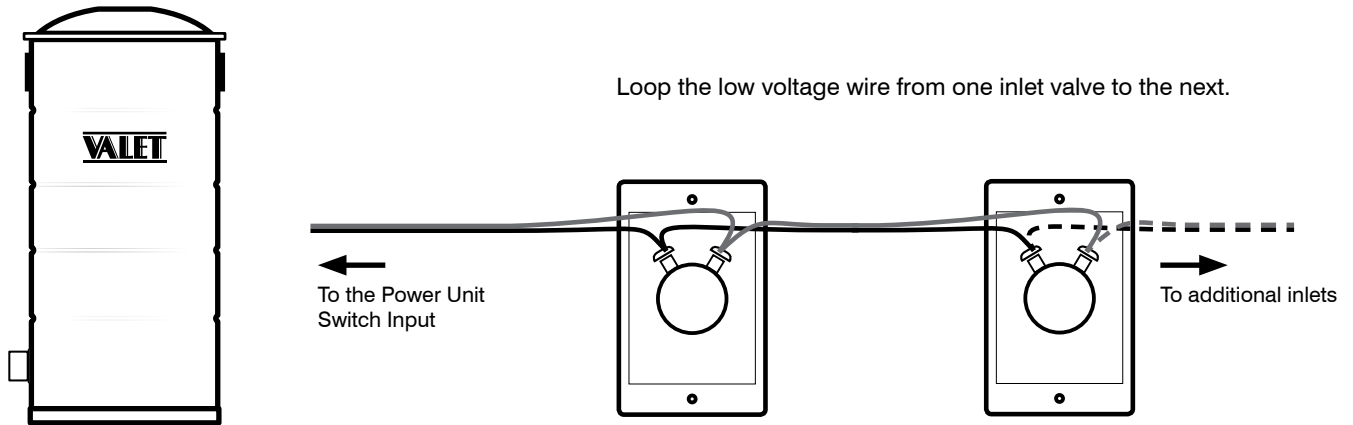

CONNECTING THE SWITCH INPUT

Your Valet power unit may have one of several types of Switch Input for connection to the low voltage wiring. The purpose of the Switch Input is the same in all cases - to connect the low voltage wiring to the power unit.



Power Units fitted with the Valet Control Board.

Connect the low voltage wiring to the Switch Input using the mini plug-in terminal block provided.

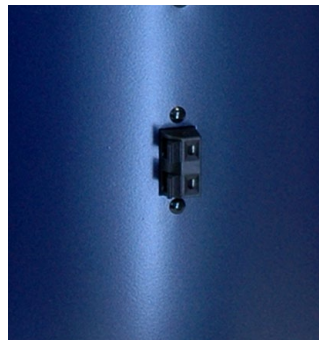

Some Power Units have a pair of spring-loaded terminals for the Switch Input.

Other types may have push-on spade terminals.

FITTING THE FILTER BAG (BAGGED MODELS)

Your Valet power unit (bagged type) is compatible with both Valet Max-Flo™ White bags and Valet Universal Blue vacuum bags. Installation of both bag types is identical.

1. Expand the bag's pleats by hand.
2. Fit the bag's rubber cuff seal over the bag adaptor
3. Valet vacuum bags are suitable for both Compact and Full height power unit canisters.

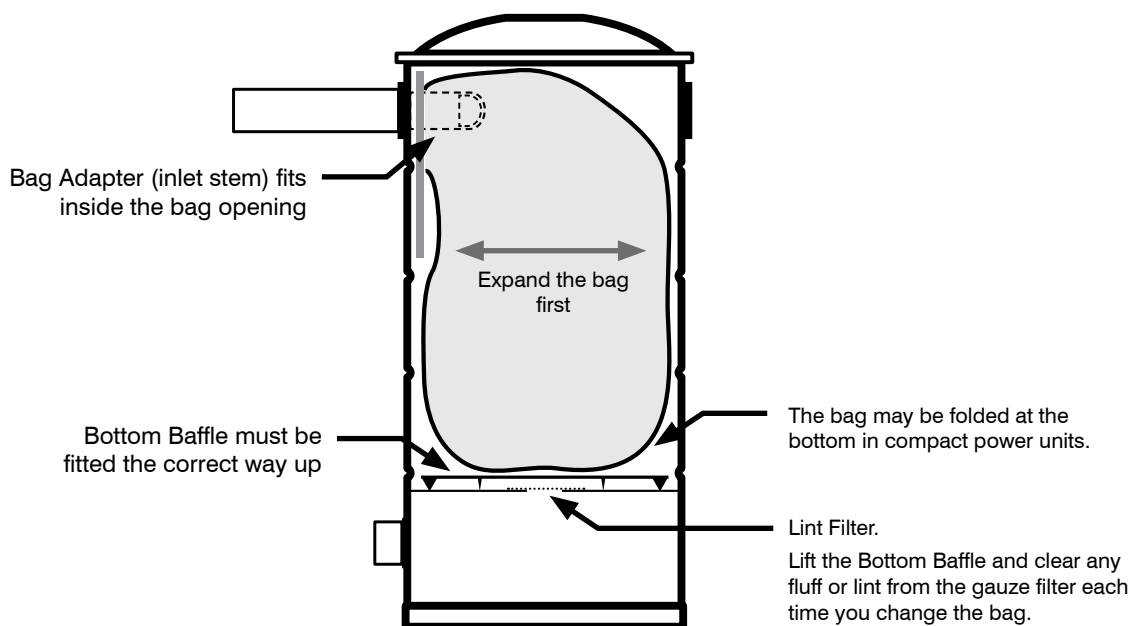

GOOD INSTALLATION STANDARDS

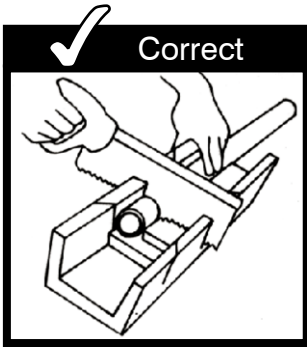

Correct

Cut PVC with a Mitre Box or Tube Cutter and deburr the cut ends with sandpaper or a de-burring tool.

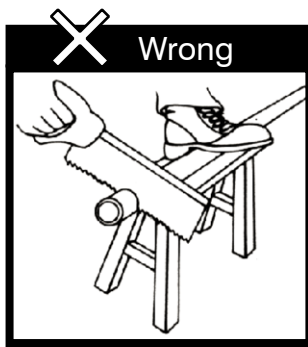

Wrong

Improper cutting will not give a clean or square end.

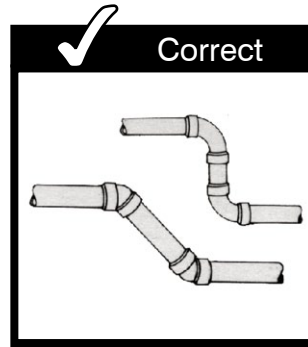

Correct

Efficient air flow.

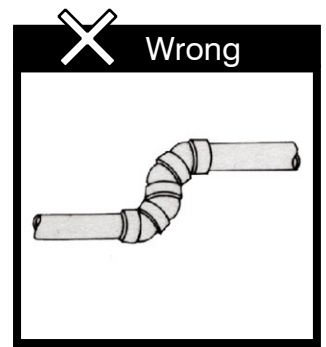

Wrong

Poor air flow.

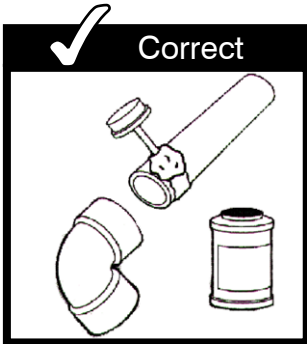

Correct

Apply glue to the outside of pipe only.

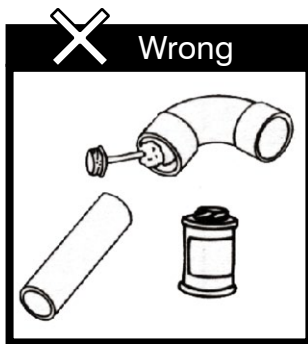

Wrong

Glue applied to the inside may accumulate and cause blockages.

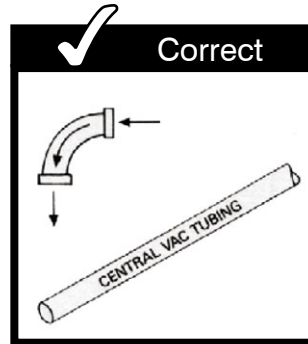

Correct

Only use approved Vacuum PVC.

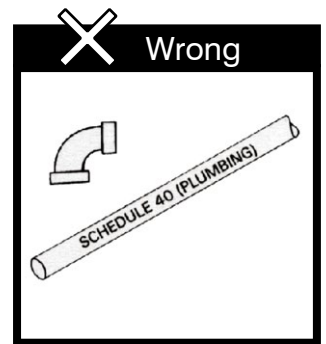

Wrong

Plumbing fittings are not designed for efficient air flow.

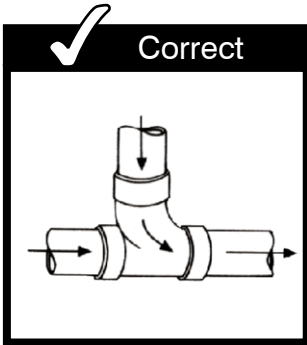

Correct

TY in the right direction.

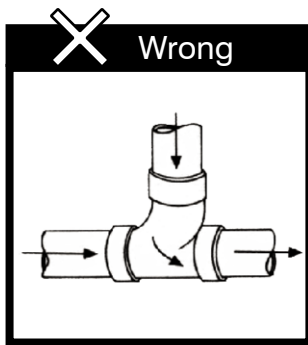

Wrong

TY in the wrong direction.

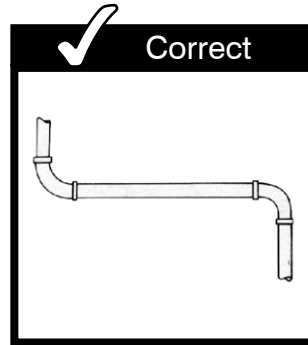

Correct

90° sweeps provide best efficiency.

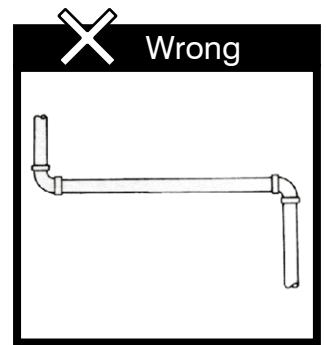

Wrong

90° short elbows reduce efficiency.

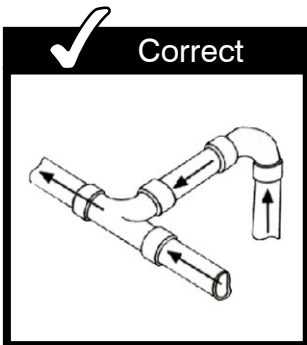

Correct

Dirt should flow from the side or top of PVC ducting.

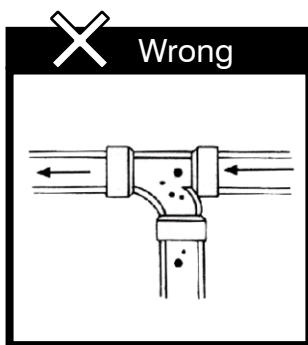

Wrong

Gravity can cause dirt to fall down the wrong line.

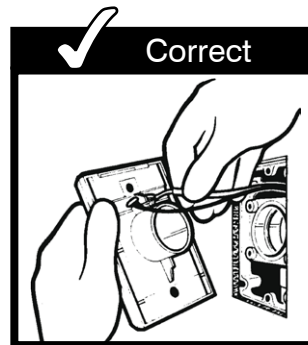

Correct

Loop the wire at inlet points so the connection is easily accessible for service.

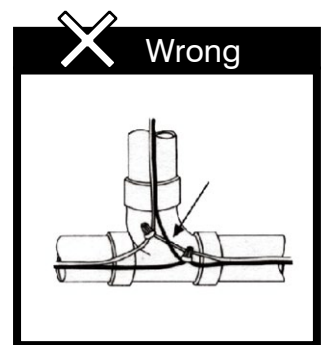

Wrong

Connections joined at junctions may be difficult to access later for service.

INSTALLATION

No doubt you will have planned the Installation, understood the Good Installation Standards, and are prepared for a smooth Installation.

Check that you have the correct material and proper tools to complete the job without disruption.

Ideally, you will have already completed some training or at least been involved with another Central Vacuum Installation, so you will have picked up some valuable knowledge.

In any event, the following tips may help you:



PVC DUCTING

The international standard size for PVC Ducting is 2 Inches OD (50.8mm), so in Australia, the ducting is generally only available from dedicated Central Vacuum suppliers and installers.

As quality will vary, it is recommended that you avoid poor quality PVC which may frustrate you with too loose or too tight assembly with the fittings.

Accurate cutting, proper cleaning, and gluing is critical to avoid leaks and possible future blockages.

Care is required when installing in new home constructions so that the ducting is not damaged or fixed in locations that may interfere with other trades. Any resulting leak after the ducting is covered by a wall may prove difficult to repair.

Do not install PVC Ducting within concrete slabs.



PVC FITTINGS

As per the PVC Ducting, the international standard size for PVC fittings is 2 inches ID (50.8mm), and are generally only available from dedicated Central Vacuum Suppliers and Installers.

Poor quality fittings should absolutely be avoided. Loose fittings may leak and tight fittings will slow down the installation time, and will have a tendency to crack.

Always use the most appropriate fitting that will provide the most efficiency in air flow, rather than use the fitting that you may be on hand at that time.

Do not apply glue to the fitting, as glue applied to the inside of a fitting may be pushed ahead and create a rough bead which will reduce airflow and may cause a blockage.

The ducting should be inserted all the way into the fitting and turned a quarter of a turn to distribute the glue evenly.

INLET VALVES

Valet inlet valves are available in a variety of models for different applications.

Standard Series valves are the most common and will fit most existing wall valve openings. The iStyle designer series offers a choice of attractive colours and finishes to complement any decor.



Utility Valve for an extra point in the garage.

The valves are generally available with either a “pin jack” arrangement, where, on inserting the hose, the pins are shorted and the Vac is switched on (Standard Series and iStyle), or will have a micro switch in the valve which is activated by the hose cuff (Utility valve).

Most wall valves are internationally compatible with most hoses although there may be exceptions.

For best fit and ease of installation please use the recommended back plate for wall valves.

Wall valves are usually mounted on internal walls and generally at the same height as power points for consistency, however you can choose your own height if needed. You can also consider installing a power point next to the valve if you are planning to use a high voltage hose and turbo style cleaning head.

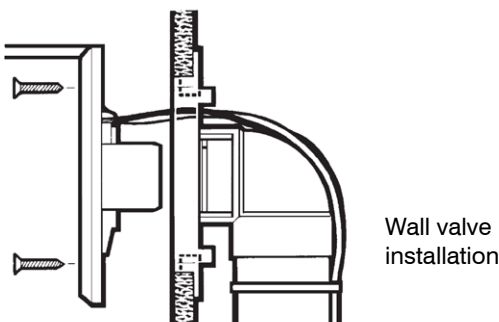

In some cases, you may need to mount the Wall Valve on the floor, particularly in homes that are already built and access to the wall space is difficult.

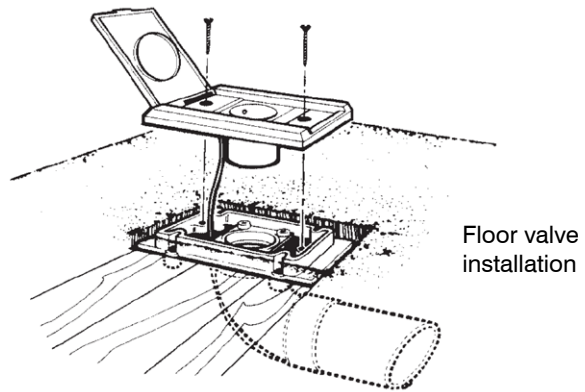

Take time and pay attention to finding the best location for the wall valves so that they cover the greatest area of cleaning, reducing the need to move the hose too often from valve to valve. A standard hose is 9 metres and is a good manageable size, however, if absolutely necessary, longer hoses are available.

GLUE

The PVC glue is actually a solvent which melts the pipe and fitting together. There are different qualities of glue and different glues dependant on the application.



- Clean surfaces before gluing.
- Apply glue to pipe not fittings.

In Australia, you should use the Blue PVC glue. Green (which has greater strength) may be used if Blue is not available. Do not use Clear glue which is made for non pressure applications.

Ensure that the ducting and fittings are free of dirt, grime and burrs. Always wipe both surfaces with a clean cloth and if there is excess grime or foreign matter you should clean the areas with a pink PVC primer before applying the glue.

Only apply the glue to the ducting, as glue applied to the inside of a fitting may be pushed ahead and create a rough bead which will reduce airflow and may cause a blockage. The ducting should be inserted all the way into the fitting and turned a quarter of a turn to distribute the glue evenly.

EXISTING HOMES

Installation of a central vacuum system in existing constructions is not only possible but in most cases is quite simple.

While there can be extra challenges to installing in some existing houses, often the installation is much easier than anticipated.

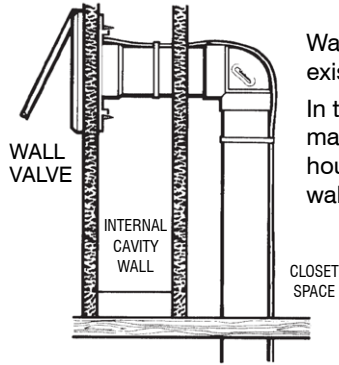

Wall valve installed in an existing home. In this case, installation is made easy from under the house and through a closet wall.

Many houses may only require two or three wall valves, and access to these may sometimes be made underfloor, or through a cupboard as an example.

NEW INSTALLATIONS

Double brick or concrete constructions will require greater planning and expertise, and often may involve the assistance of the builder. This guide is not intended to address those types of installations or applications.

In relation to the standard timber frame construction, the PVC ducting will be installed at "frame stage".

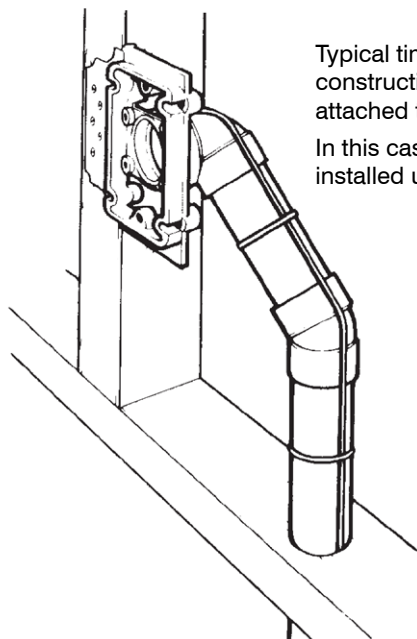

Typical timber or steel frame construction. Mounting plate attached to a stud. In this case the PVC pipe is installed underfloor.

Once the Inlet Valve location has been decided, the mounting plate can be fixed to the stud with nails or screws. Ensure you have chosen the best height,

which may often be at the same height as power points for consistency.

The PVC duct, together with the low voltage wiring will run through to the bottom plate, or up through the nogging and top plate.

Once the home is completed, the inlet valves can be installed, preferably after the walls have been painted. The two lugs on the wall valve will be connected to the cable, or 2 cables if the wiring at that valve is looped to the next wall valve.

Hold the wall valve with the hinge at the bottom, and with a twisting motion, slide the rear of the valve into the mounting plate. Do not use glue as the gasket in the mounting plate will provide a positive seal. If the valve does not reach the mounting plate an inlet valve extension can be used.

Flaps up or down? Many people prefer to install wall valves with the flap hinging downwards for easy access to the inlet. There is no correct way - hinge up or hinge down is up to your personal preference.



Simply screw the wall valve to the mounting plate to complete the task. If the PVC ducting is directly behind the screw locations be sure to use short screws that will not reach and puncture the duct.

VACUUM HOSES



Standard Hose. Plug in to the inlet valve to turn on the power unit.

Available in 9m, 10m & 12m lengths.

Switch Hose with the convenience of an On/Off switch on the handle.

Available in 9m, 10.5m & 12m lengths.

Also available:

Hose extenders in 3m, 5m & 6m.

Quick Care Stretch Hose extends to 9m and collapses down to a convenient 3m.

9m Speed Control Hose with On/Off and variable speed slider switch for use with compatible power units.

A variety of Valet vacuum hoses are available including, standard hose, switched hose, speed control hose, wireless switched hose and high voltage hose.

Generally these are interchangeable, although it is always best to decide which hose is to be used in advance of the installation process.

Importantly, the standard hose length of 9 metres is a good manageable size, however, if absolutely necessary, longer hoses and hose extensions are available.

CLEANING TOOLS & ACCESSORIES



A wide variety of floor tools and brushes are available from your Valet dealer or at Valet online.

You will need at least a hose, a telescopic wand and a floor tool (a combination tool being the most versatile and popular choice).

From there you can choose from a wide variety of useful accessories for your cleaning toolkit, just ask your Valet dealer.

SPECIAL APPLICATIONS

There will be many special applications that may require greater knowledge, expertise or assistance. It is not recommended that you attempt difficult installations without seeking advice or assistance which is readily available.

For example, homes with flat roofs and slab floors may require external ducting, or ducting that may be best trenched around the home.

Similarly, double brick or concrete constructions will require greater planning and often may involve the builder. This guide is not intended to address those type of installations or applications.

INSTALLATION PLAN

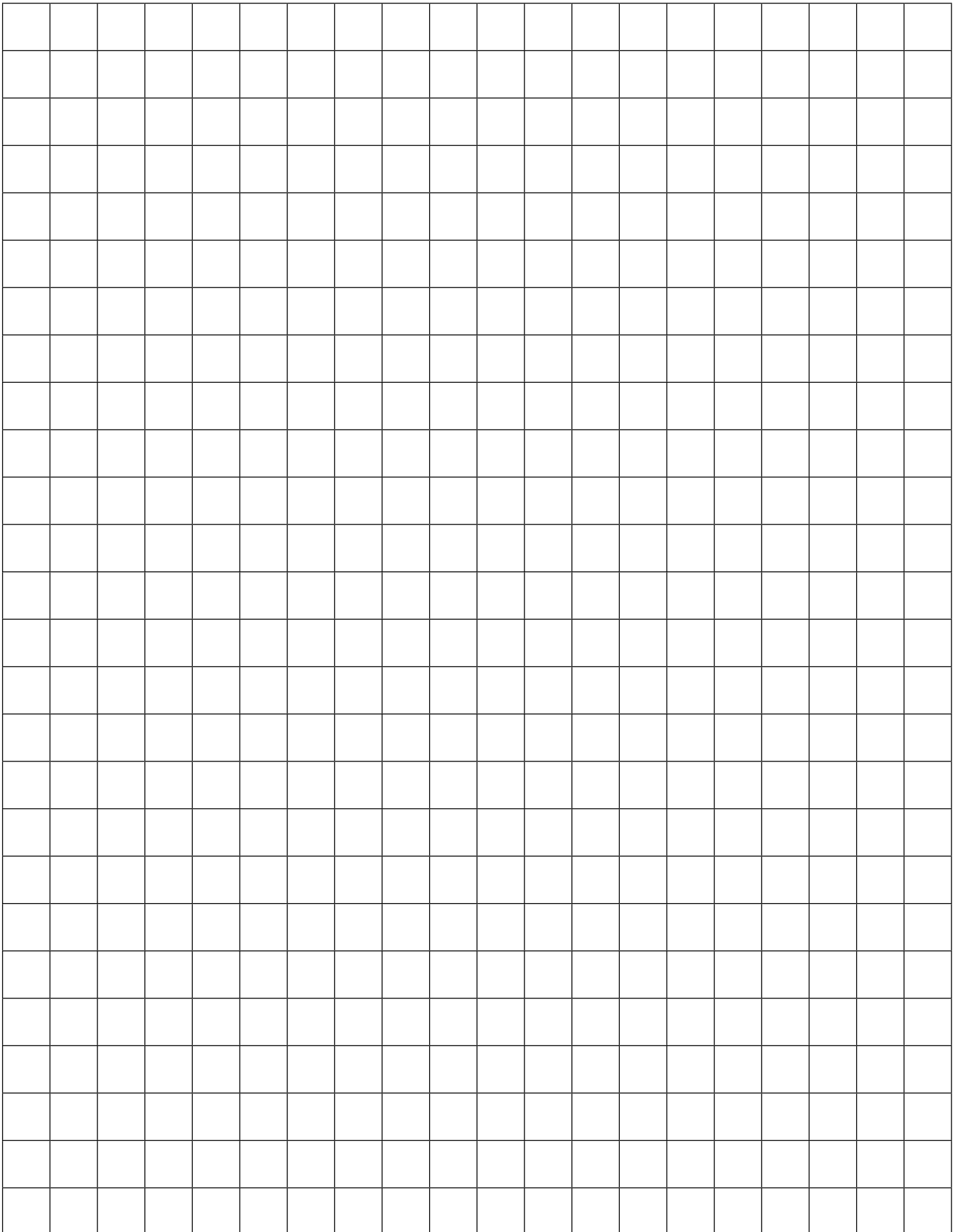

OPERATION AND CARE

CONTENTS

Operating Your Central Vacuum System, Overview	16
How To Change The Bag (Bagged units).	17
How to Empty The Dirt Canister (Cyclonic & Inverted bag units)	18
Troubleshooting Guide	19
Troubleshooting Guide, Remedies.	20-22
Warranty Card	23-24



OPERATING YOUR CENTRAL VACUUM SYSTEM

Your central vacuum system has been engineered for a long, trouble-free service life. Your power unit is covered by a factory limited warranty that is enclosed with these instructions.

Please read your limited warranty carefully. If your owner's manual came with a warranty card, fill it out and return it to Valet within ten (10) days of installation. Return the card to the free post address on the card or register your warranty online. Remember, your warranty does not cover abuse or misuse of the equipment.

If your owner's manual did not come with a warranty card you can register online at www.valet.com.au

HOSES AND CLEANING TOOLS



It is very important to utilise the tool that is designed for a particular cleaning job in order to obtain full efficiency from your system. There are also a range of other special carpet & flooring tools available, which are not included as part of the normal tool kits. For example, these include, a vibrating upholstery tool, a pet grooming tool, and a hand held air turbine. In addition, there are accessories designed to allow you to safely pick up liquids with your cleaning system such as the Wet Pick-Up. Each of these tools is available for purchase from your local dealer.

VACUUM INLETS



When opening the door of the vacuum inlet valve to insert the hose, care should be taken not to distort the door by forcing it too far open. Do not try to open the door of another inlet while the power unit is running as the suction may pull the rubber gasket from the door.

If using a standard hose hold the inlet valve's door open for a few seconds after removing the hose until the suction stops. Do not let the flap slam shut with the motor still running as this may damage the motor or the inlet valve.

If the power unit continues to run after the hose is removed from the inlet, disconnect the electrical supply to the power unit and notify your local dealer or serviceman.

POWER UNIT MOTOR

Your Valet Power Unit motor uses sealed bearings which require no oil or other maintenance.

Your Power Unit, depending on the model, may have a thermal switch, circuit breaker or fuse which act to turn off the unit in the event of a power surge or overheating.

If your unit stops working please consult the Troubleshooting guide on page 19-22 or call your Valet service dealer.





SEALED PAPER BAG SYSTEMS

Sealed Bag units either use the blue Valet universal two layer paper bag, or the white Valet Max-Flo™ HEPA multi layer synthetic bag that offers greater efficiency. Both provide superior filtration, are low cost and easily disposable.

The bag is a convenient and reliable storage method to collect all of the dirt and debris when vacuuming with your central system.

Always use genuine Valet vacuum bags.

HOW TO CHANGE THE FILTER BAG



⑤

① Remove the lid off the canister by lifting up. There are no hinges or clamps on most power units.



② Remove the full bag by sliding the bag's rubber cuff and collar off the plastic inlet stem (bag adaptor) inside the canister. Once the bag is off the inlet stem, seal the dirt in using the self-adhesive tab provided on the bag's collar. Then lift the paper bag from the dirt canister and dispose in your normal household rubbish bin.



③ Take a new bag of your choice, blue or white. For best performance the bag should be expanded before installation by simply pulling on opposite sites of the bag.



④ Insert the bag in the canister and slide the bag's rubber gasket onto the inlet stem until it seals in the inlet stem's groove.

⑤ Carefully replace the lid on the dirt canister to ensure that it seals properly or it could cause a vacuum leak and reduce the cleaning efficiency of your system.

NOTE: The Lint Filter inside the canister should be inspected and cleaned each time you change the bag, especially if you notice a large amount of dust inside the canister which could indicate that the bag has burst or fallen off the inlet stem. See Cleaning The Lint Filter.

HOW OFTEN SHOULD I CHECK OR EMPTY THE FILTER BAG?

The filter bag should be changed when it has accumulated 100–150mm of dirt or any time there is a noticeable reduction of air flow at the cleaning tool. Initially, the bag should be checked or emptied monthly until you have an idea as to how long it takes to half fill the bag under your normal cleaning routine.

All vacuum systems will function more effectively if they are emptied frequently. Under no circumstances should you allow your bag to become more than 3/4 full before emptying.

Note: The bag will fill more rapidly when cleaning NEW carpets. There is usually a tremendous quantity of loose fibres retained in the carpet from the manufacturing process. In some instances it may take several months before all of these loose fibres are removed from new carpets.

CLEANING THE LINT FILTER

Clear any fluff or lint from the gauze filter each time you change the bag.

INSIDE THE CANISTER

Remove the bag then lift up the Bottom Baffle to reveal the Lint Filter.

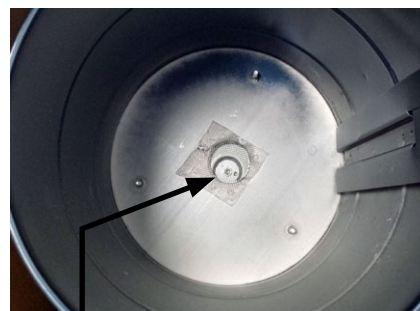

Remove any fluff or lint from the Lint Filter then replace the Bottom Baffle.



CYCLONIC & INVERTED BAG SYSTEMS

The volume of dirt and debris picked up by your central vacuum system is deposited in the dirt canister or inverted bag. The dirt canister is attached to the bottom of your power unit (single canister units) or filter canister (if split system unit) and will need to be emptied on a periodic basis. To empty the dirt can or inverted bag, follow these simple steps:

HOW TO EMPTY THE DIRT CANISTER

Single Canister Units



1. To remove the dirt canister, support the bottom of the canister with your knee¹, then unsnap the two dirt canister latches by grasping the lower end of each latch and pulling straight away from the canister. (Note: The latches may be tight, but do not try to adjust them. They need to latch tightly, to ensure a proper seal, which is important in the operation of the cyclonic separation.)

2. Carefully lower the dirt container and empty the debris into any suitable trash container.

3. **CYCLONIC UNITS** - check the vacuum protection screen by looking up or feeling up inside the dirt canister to remove any debris that may have become stuck on the screen up inside the metal cone. A plastic bag may be placed over the bottom portion of the top canister. Then, while holding the plastic bag tightly around the canister with one hand, push the bag up inside with the other hand and brush the screen surface. In this way, the screen can be cleaned without getting any dust or debris on the floor or hands.



Some Cyclonic units may have an optional Electro-Static screen. To remove the screen, pull down on the tab until the screen comes down through the metal cone. Clean the electrostatic screen by vacuuming, rinsing with water, or shaking. **IMPORTANT:** If you rinse the screen, make sure it is dry before placing it back in the unit or it will void warranty. To replace the screen, fold it and place it inside of the top of the metal cone. Then, allow the Electro-Static screen to expand until it covers the entire opening.

INVERTED BAG UNITS - It is not necessary to remove the inverted bag to clean. A plastic bag may be placed over the bottom portion of the top canister. Then, while holding the plastic bag tightly around the canister with one hand, push the bag up inside with the other hand, and brush/shake the bag surface to loosen any dust and debris that may have accumulated on the bag. In this way, the bag can be cleaned without getting any dust or debris on the floor or hands. Ideally, the bag should be cleaned every time you empty the dust bin.

4. Replace the dirt canister by slipping the rim of the dirt canister over the lip of the top can until it is seated against the rim gasket. Then while holding the canister in place with your knee¹, fasten the two latches. Do this by hooking the top lip of each latch over the rim of the top can and then press straight in on the bottom of the latches until they lock.

TROUBLESHOOTING GUIDE

Your Valet Vacuum System has been engineered and manufactured to provide many years of carefree service. Should your system fail for any reason, the following chart and instructions will assist you to restore good working order.

CAUSE	SYMPTOM				
	NO AIRFLOW	LOW AIRFLOW	POWER UNIT DOES NOT RUN	POWER UNIT CONTINUES TO RUN	POWER UNIT CYCLES ON & OFF
See the list of probable causes on the following pages.					
1. Power Cord	•		•		•
2. Unit Circuit Breaker or Fuse	•		•		
3. Home Circuit Breaker	•		•		
4. Unit Thermal Switch (some models)			•		
5. Electrical power point	•		•		•
6. Wall Inlet switch stuck off			•		
7. Wall Inlet switch stuck on				•	
8. Low voltage wire broken	•		•		•
9. Low voltage wire shorted				•	•
10. Flexible hose blocked	•	•			
11. PVC ducting blocked	•	•			
12. Dirt canister overflow		•			
13. Filter bag clogged		•			
14. Dirt canister lid is off or not seated	•	•			
15. Dirt canister gasket loose		•			
16. Outside exhaust blocked	•	•			
17. Dirt canister not latched		•			
18. Wall inlet valve door open		•			
19. Lint filter clogged	•	•			
20. Relay stuck on				•	
21. Relay stuck off	•		•		
22. Control PCB Faulty	•		•		
23. Loose internal connection in unit	•		•		•
24. Hose plugged into another valve				•	
25. LED Light is off			•		
26. Cannot turn off using switch hose				•	

TROUBLESHOOTING GUIDE

POSSIBLE CAUSE DESCRIPTIONS

1. Power Cord

Make sure that the power cord is plugged into the power point and that the power point is working and is turned on.

2. Unit Circuit Breaker or Fuse

If your unit has a circuit breaker, it may have tripped (popped out) due to overheating or a power spike. Check the button and push to reset. If the button pops out again call your service technician. On units with fuses, check and replace with correct fuse. If the fuse blows again, call for service.

3. Home Circuit Breaker

Check your home electrical fuse/breaker board. If the fuse has blown or circuit breaker tripped, there may be too many electrical appliances on the same circuit. You may need to unplug some of these or move some to another circuit. If the problem continues you may need to call your electrician.

4. Unit Thermal Switch (some models)

Some Vacuum models have an internal thermal switch that when overheated will stop the unit running. It may require a period of 10 to 20 minutes to cool before it will automatically reset.

5. Electrical power point

Check that the power point is working by plugging a lamp or other electrical device into the point. If faulty, the Vacuum can be plugged into another power point if available nearby while you have your electrician rectify the fault.

6. Wall Inlet switch stuck off

To check, plug your flexible hose into another wall valve. If that works, the inoperative wall valve may have a loose or faulty micro switch, or the hose metal band may not be making contact with pin jacks on the valve. The cable fixed to the rear of the valve may have become dislodged. If the switch can't be tightened or if the problem is not obvious you will need to call your service technician.

7. Wall Inlet switch stuck on

If your wall valve has a micro switch (older models and utility valves only), check that the steel ball located at the neck of the valve inlet is not stuck. Rolling the ball with your finger may loosen any

foreign material lodged there that may have trapped the ball. If the Vacuum continues to run, turn the Power unit off at the power point and call your service technician.

If your wall valve has two pins inside the neck (most modern models) check that the pins are not broken off and can retract freely when pushed in.

8. Low voltage wire broken

Usually, if more than one wall valve is inoperative the problem may be caused by a fault in the low voltage cable. If the cable is only terminated behind each valve and at the Power unit, a visual inspection may locate the problem. If the cable is faulty behind a wall, your service technician will likely be required. In the even that a broken cable exists in an inaccessible location, the addition of a wireless switching device may be required to rectify the problem.

9. Low voltage wire shorted

Unplug the low voltage wiring at the Power Unit. If that stops the unit running, there will be a short circuit in the wiring or a wall valve may have a stuck switch, as outlined in "7" above. If the unit does not stop, there will be a fault inside the unit as outlined in "20" below, and will require your service technician to carry out any repairs.

10. Flexible hose blocked

If airflow through the hose is poor, remove the hose from the wall valve, and start the Power unit by pushing the metal ball in the valve or by shorting out the two pins. If the airflow at the valve is good, there will likely be a blockage in the hose or wand.

If the blockage is in the wand, it can be disassembled and cleaned.

If the blockage is in the hose, lay the hose out straight, then with the hose plugged into the wall valve and the Power unit running, gently stretch the hose starting at the furthest end from the valve, working towards the valve. If this is not successful, reverse the hose by unscrewing the handle and hose cuff and swapping them to opposite ends of the hose (depending on the type of hose and if the hose ends can be unscrewed) and run the vacuum by plugging the reversed hose it into the wall.

If that does not clear the blockage, there are additional options that may help, including:

- Pushing a long PVC conduit through the hose

- Running a screwdriver with a handle diameter of at least 20mm through the hose, handle first.
- Hold one end of a 10 to 12 metre length of string and vacuum the other end through the hose. Switch off the Power unit, and attach a brush or other similar object to one end of the string, pulling the string and object through the hose.

11. PVC ducting blocked

Check the airflow at the Power unit. If there is good flow there but not at all wall the valves, the PVC ducting behind the wall may be cracked, broken or blocked. You may need to call your service technician.

If you prop open furthest wall valve and run the Power unit by shorting out its low voltage pins, you may determine if you have a blockage or a break.

If there is little air flowing out of the Power unit exhaust, there is likely to be an obstruction in the ducting rather than a break. You could try plugging in the nozzle of a portable vacuum unit into a wall valve which may suck out the obstruction.

12. Dirt canister overflow

If you have a bagless Cyclonic Power Unit, a full or overflowing dust bin will impede the efficiency of your unit resulting in poor performance.

While your system newly installed it is advisable to check the dust bin regularly until you develop a sense of how long it takes to fill the bin.

13. Filter bag clogged

If you have a paper or cloth bag Power Unit, a full bag will impede the efficiency of your unit resulting in poor performance.

While your system newly installed it is advisable to check the bag regularly until you develop a sense of how long it takes to fill the bag.

Very fine material such as concrete dust can clog a bag very quickly. Vacuuming such materials is not recommended.

If vacuuming of fine material is unavoidable, the bag should be replaced immediately after the cleanup is completed or during the cleanup if there is a loss in performance while vacuuming.

14. Dirt canister lid off

If your Vacuum Power unit has a lid, the lid must be placed squarely on the top of the dirt canister, otherwise the vacuum will leak causing a reduction or complete loss of suction.

15. Dirt canister gasket loose

If the dirt canister gasket has been dislodged or is loose, there will be a vacuum leak which will also significantly reduce any performance. The seal may need to be glued back into position.

16. Outside exhaust blocked

If there is poor air flow at the end of the exhaust line, but the air flow is better at the exhaust on the power unit with the exhaust line removed, there will be a blockage in that section of PVC ducting.

You may need to call your service technician.

17. Dirt canister not latched

If your Power unit has a latching clips on the lid or dirt canister, ensure it is properly closed or latched, as any leak will greatly reduce performance.

18. Wall inlet valve door open

Only one inlet wall valve should be opened for use at any one time. A slight opening or leak in any valve other than the one you are using will greatly reduce performance.

19. Lint Filter clogged

The lint filter located under the bottom baffle may clog, causing poor performance, if the dirt canister is overflowing or the bag has burst. This metal gauze lint filter is easily accessible under the bottom baffle and should be checked each time the bag is changed. See Page 17. Cleaning The Lint Filter

20. Relay stuck on

Some Power units may have an internal relay, rather than a solid state control board to switch the unit.

As mentioned in "9" above, if you have unplugged the low voltage wiring, and the Power unit still runs, then you will need to switch the Power unit off at the power point.

Internal service to the Power unit should only be carried out by qualified persons. Please call your service technician.

21. Relay stuck off

Some Power units may have an internal relay, rather than a solid state control board to switch the unit.

If the procedures described in 1, 2, 3, 4, 5, 6, or 7 do not correct the problem whereby the unit won't start, there could be a fault in the relay, the internal transformer, or a loose connection in the Power unit.

Internal service to the Power unit should only be carried out by qualified persons. Please call your service technician.

22. Control PCB Faulty

Some Power units have a solid state control board instead of a relay.

If the procedures described in 1, 2, 3, 4, 5, 6, or 7 do not correct the problem whereby the unit won't start, there could be a fault in the Control PCB, or a loose connection in the Power unit.

Internal service to the Power unit should only be carried out by qualified persons. Please call your service technician.

23. Loose internal connection in unit

Refer to "21" and "22" above.

24. Hose plugged into another wall valve

Refer to "18" above.

25. LED Light

Some Power units have an LED light on the side of the canister to tell you there is power at the unit. If the light is not on, refer to "5" above.

26. Cannot turn off using switch hose

Ensure the hose is plugged into the inlet valve with the hose cuff locating lug in the correct position. Rotate the hose cuff so the lug sits between the two locators correctly.

WARRANTY

CENTRAL VACUUM – INTERCOM – SECURITY – AUTOMATION

IMPORTANT

Please keep this Warranty card in a safe place. The benefits conferred by this Warranty are in addition to all other rights and remedies in respect of the product which the consumer has under Australian Consumer Law.

- This Warranty:
 - All Products – 90 day cover, after installation. On site cover for defective workmanship or material will be at no cost for systems installed by an authorised Dealer.
 - Intercom Systems – Two years cover. iCentral will replace or repair any defective component for 24 months from the date of purchase. The purchaser is responsible for return freight costs to the nearest Dealer.
 - Security Systems – Two years cover for products manufactured by Ness Corporation. iCentral will replace or repair a defective component for 24 months from the date of purchase. The warranty period for equipment supplied by iCentral but not of Ness manufacture will be 12 months unless stated otherwise. Security products are not covered by an on site warranty and must be returned to iCentral for claims. The purchaser is responsible for return freight costs to the nearest Dealer.
 - Central Vacuum POWER UNIT ONLY including iCentral and Valet brands – Five years cover (except V-TEN model which is ten years for domestic use). iCentral will replace or repair any defective component during the warranty period. The purchaser is responsible for return freight costs to the nearest Dealer.
 - Replacement Vacuum Motors, Vacuum Tools, Hoses, Brushes & Vacuum accessories – One year cover. iCentral will replace or repair any defective component during the warranty period. The purchaser is responsible for return freight costs to the nearest Dealer.
 - Bonus Warranty – A further one year warranty is offered at no charge by the purchaser completing and returning the Warranty Card or register online at www.valet.com.au or www.icentralsystems.com.au
- This Warranty will not apply to, or if:
 - The product is damaged by the use of an accessory which is not supplied by iCentral.
 - The product is misused, neglected, or altered by any person, or is damaged by incorrect installation.
 - The product is opened, disassembled, or serviced by a person other than an iCentral recognised Dealer or repair agent.
 - Consumables, including batteries are not covered by this warranty.
 - Interference caused by external fields, including appliances, dimmers, radio transmitters, electrical cables, and unstable voltage is excluded from this warranty.
- Under this Warranty:
 - Product defects covered by this Warranty will be repaired, during normal business hours, at the premises of iCentral's recognised Dealer or the recognised repair agent without cost to the owner for parts and repair labour or, at the option of iCentral, the product will be replaced.
 - The purchaser is responsible for all transport costs and in-transit insurance costs if the product or part has to be returned for repair to iCentral's recognised Dealer or repair agent. iCentral will not accept responsibility for damage to the product caused by unsuitable or inadequate packing.
 - The purchaser is at all times responsible for the repair of defects caused by accidental or intentional damage, improper voltage, fire, misuse, abuse, neglect, alterations by or negligence of the consumer, incorrect or incomplete installation or operation by the consumer, Acts of God, vermin or foreign matter such as dirt and moisture entering the product.
 - For repair of the product under this Warranty:
 - The Dealer or repairer should be contacted within thirty (30) days of the fault developing.
 - Proof of purchase must be presented to an iCentral recognised dealer or repair agent.
- Various warranties or conditions may be implied or obligations may be imposed on iCentral by provisions of Australian Consumer Law. If any such provision applies, then to the extent permitted by law and to the extent that this Warranty is given in addition to such warranties or conditions, any liability under this Warranty is expressly limited to:
 - In the case of products, the replacement of the product, the payment of the cost of replacing the product, or of acquiring an equivalent product, at the discretion of iCentral; and
 - In the case of services, supplying the services again, or the payment of the cost of having the services supplied again, at the discretion of iCentral.
- This is the only Warranty given by iCentral on this product. No other person or non-statutory organisation is authorised by iCentral to vary the provisions and conditions of this Warranty.
- This Central warranty aims to provide customers with protection in addition to rights under Australian Consumer Law. In any case where the terms of this warranty and Australian Consumer Law differ, we will offer the remedy which provides the greater protection.

Our goods come with guarantees that cannot be excluded under the Australian Consumer Law. You are entitled to a replacement or refund for a major failure and for compensation for any other reasonably foreseeable loss or damage. You are also entitled to have the goods repaired or replaced if the goods fail to be of acceptable quality and the failure does not amount to a major failure.

iCENTRAL SYSTEMS - A division of Ness Corporation Pty Ltd ABN 28 069 984 372

Head office: Unit 4 / 167 Prospect Hwy Seven Hills NSW 2147 Australia

iCentral & Valet service enquiries to Ph: 02 8825 9222 Fax: 02 9838 8685

Email: sales@valet.com.au
Web: www.icentralsystems.com.au / www.valet.com.au / www.ness.com.au



THE HOME OF



Return this Warranty Card for
ONE ADDITIONAL YEAR of bonus warranty
provided at no charge.

Or register your warranty online at www.valet.com.au

CENTRAL VACUUM POWER UNITS

5 Years Warranty + 1 Year Bonus Warranty
(V-TEN Power Unit has 10 years warranty for domestic use)

INTERCOM SYSTEMS & SECURITY SYSTEMS

3 Years Warranty + 1 Year Bonus Warranty

VACUUM TOOLS, BRUSHES, ACCESSORIES

1 Year Warranty + 1 Year Bonus Warranty

REPLACEMENT VACUUM MOTORS

1 Year Warranty applies to either owner-installed or dealer-installed replacement motors

FOLD HERE TO KEEP YOUR
PRIVATE DETAILS HIDDEN

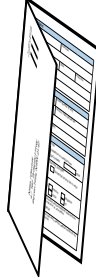

Staple or tape this card folded and drop in a mailbox. No postage stamp required if posted in Australia

TEAR OFF

YOUR DETAILS

First Name _____ Surname _____

Address _____

City/Suburb _____ State _____ Postcode _____

Phone (_____) _____

Email address _____

PRODUCT DETAILS

Model Number _____ Serial Number (if any) _____

Date of purchase _____ / _____ /20__-__-__ Invoice / Sales Docket No. _____

Dealer / Retailer's Name _____

Dealer / Retailer's Location (Suburb & State) _____

SURVEY

INSTALLATION OF YOUR SYSTEM

Installed in a new home Installed in an existing home
 Installed by a Dealer Self-installed Other _____

HOW SATISFIED ARE YOU WITH YOUR iCENTRAL SYSTEM?

Very satisfied Satisfied Unsatisfied (Please tell us why)

HOW DID YOU HEAR ABOUT US?

Friend/Relative Yellow Pages Internet Magazine
 Home Show Direct Mail Radio TV

STAY UP-TO-DATE: We may send you information and promotional material from time to time. If you don't want to receive mail from us, tick below.

Do not send me any promotional material

COMMENTS: We are proud of our products and we're always willing to listen to our customers. Any other comments are welcome.



Delivery Address:
Locked Bag 2023
SEVEN HILLS NSW 1730

No stamp required
if posted in Australia

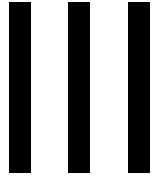

Ness Corporation
iCentral Division
Reply Paid 84232
SEVEN HILLS NSW 1730



THE HOME OF



WARRANTY CARD

LONG FACTORY WARRANTY
+ RETURN THIS WARRANTY CARD FOR
ONE ADDITIONAL YEAR OF BONUS WARRANTY